

T4J

TOP ENTRY SHUT-OFF VALVE

Data sheet
MCTW013.00 - 05/2019



- T4J is a shut-off valve
- Full flow, in accordance with the EN 806-2 standard
- TOP-ENTRY® removable ball and seals
- Single-piece body
- Suitable for domestic and industrial use, with temperature sensor and/or swivel nut for meter connection
- Chrome plated finish



Material		
Body	Ball	Control
Brass CW617	CW617 chrome plated brass	AL EN-AB44100 aluminium

TECHNICAL SPECIFICATIONS

Connections	Reference standards	Working pressure	Temperature	Application
Threaded F.	DIN EN 13828 (PN10) DVGW W 570-1	PN40 [40 bar]	0°C +150 °C	Water, heating, pneumatic, petrochemical and oil distribution systems. Suitable for non-aggressive fluids and vacuum.

VERSIONS AND CODES

Valve with probe fitting – threaded f/f version

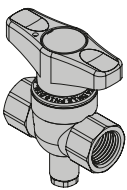

Control handle

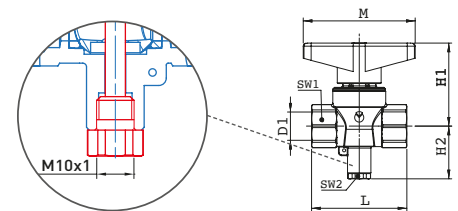

Code	DN	D1 EN-10226-1	L	H1	H2	M	SW1	SW2	Pack
T40413J0	15	Rp1/2"	63	55	32,5	74	27	14	45
T40414J0	20	Rp3/4"	73	58	32,5	74	32	14	35
T40415J0	25	Rp1"	73	88	35	94	41	14	20

TECO Srl
Via Sandro Pertini, 39/41 - Zona industriale Noccole, 25050 Provaglio d'Iseo (BS)

+39 030 6850510 | +39 030 6850555
info@tecosrl.it | www.tecosrl.it



Valve with probe fitting – threaded f/f version

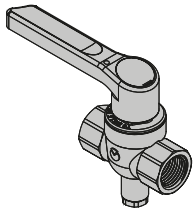

Control lever

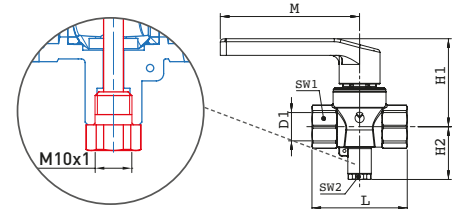

Code	DN	D1 EN-10226-1	L	H1	H2	M	SW1	SW2	Pack
T40406JO	32	Rp1"1/4	100	76	37,5	124	50	14	15
T40407JO	40	Rp1"1/2	110	82	41	147	55	14	10
T40408JO	50	Rp2"	131	88	48,4	147	70	14	5

Straight valve with probe fitting – threaded/swivel nut version

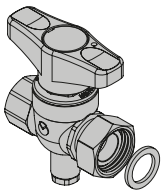

Control handle

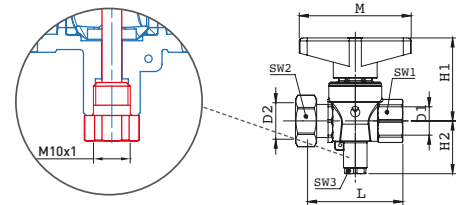

Code	DN	D1 EN-10226-1	D2 EN-228-1	L	H1	H2	M	SW1	SW2	SW3	Pack
T40413JOR	15	Rp1/2"	G3/4"	71	55	32,5	74	27	30	14	45
T40414JOR	20	Rp3/4"	G1"	73	58	32,5	74	32	37	14	35

Straight valve – threaded / swivel nut version

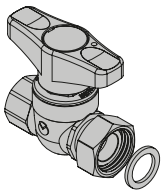

Control handle

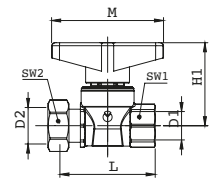

Code	DN	D1	D2	L	H1	M	SW1	SW2	Pack
T4041300R	15	Rp1/2"	G3/4"	82,5	55	74	27	30	45
T4041400R	20	Rp3/4"	G1"	84	58	74	32	37	35

Straight valve – mx threaded (ISO 228) / swivel nut version

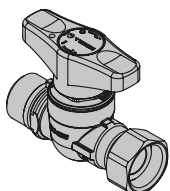

Control handle

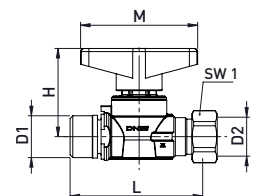

Code	DN	D1	D2	M	L	H	SW1	Pack
T403910400	15	Rp1/2"	G3/4"	74	84	55	30	10

Straight valve with extender – mx threaded (ISO 228) / swivel nut version

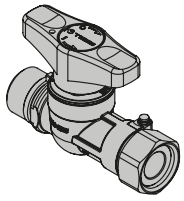

Control handle

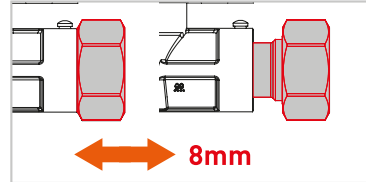

i The FASTEC EX system allows an extension of 8 mm making it easier to connect the metering units.

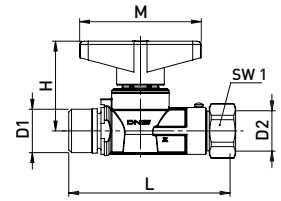

Code	DN	D1	D2	M	L	H	SW1	Pack
T403910200	15	Rp1/2"	G3/4"	74	98+8*	55	30	10

FUNCTION AND INTEGRATED TECHNOLOGIES

TECO CONTROL maintenance

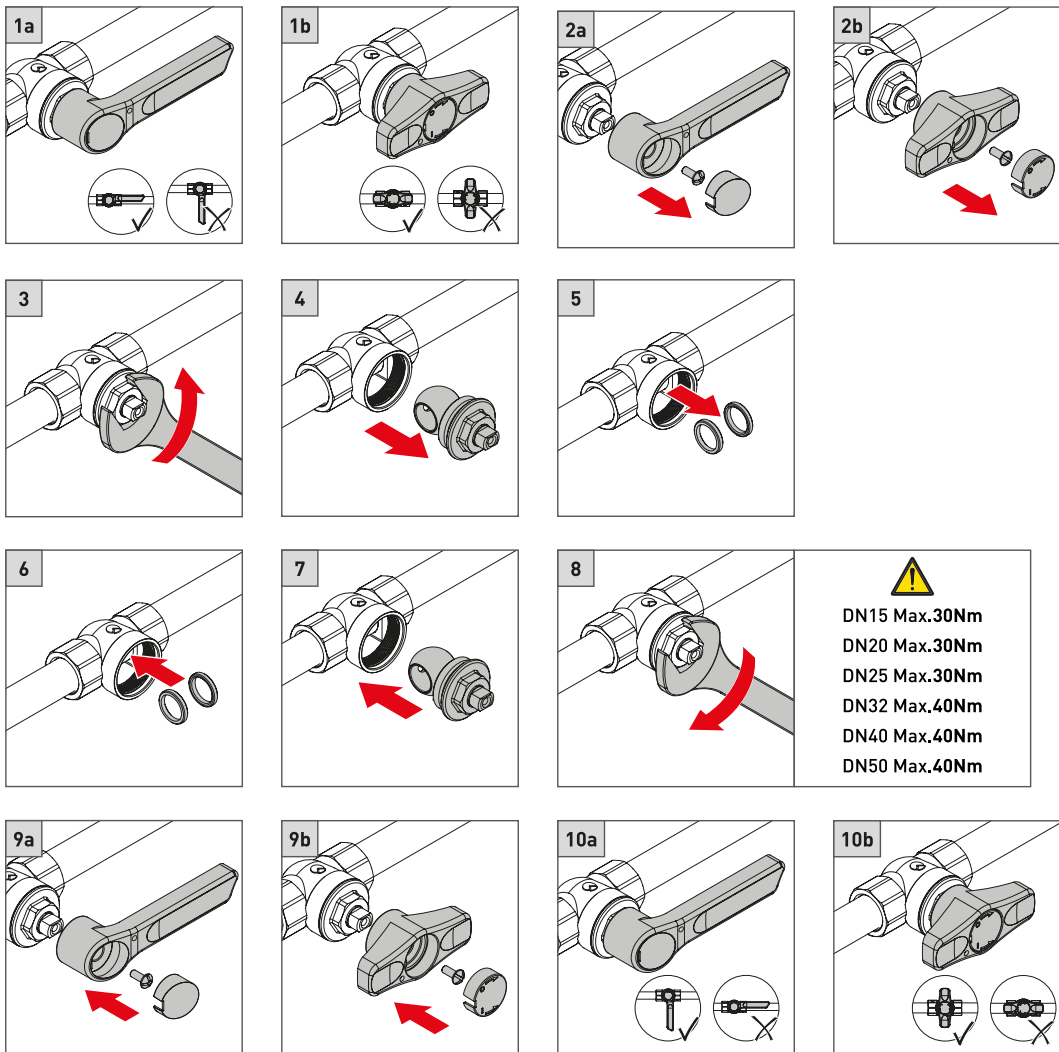

⚠
 DN15 Max.30Nm
 DN20 Max.30Nm
 DN25 Max.30Nm
 DN32 Max.40Nm
 DN40 Max.40Nm
 DN50 Max.40Nm

INSTALLATIONS AND APPLICATIONS

Metering systems

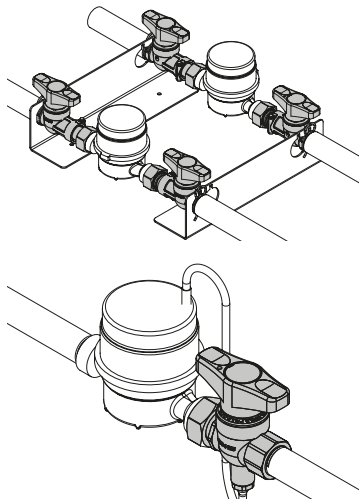

Temperature / Pressure

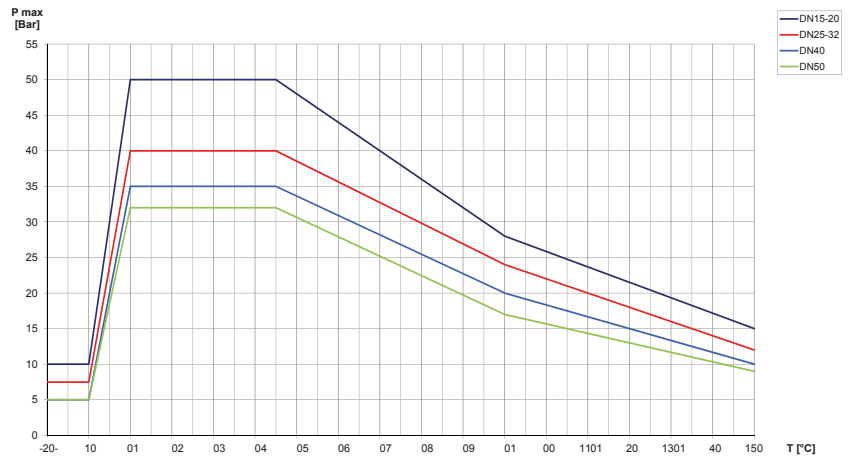

SPARE PARTS

Teco control

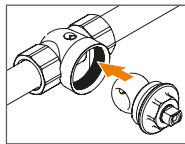

Code	DN	Pack
KRLE040100	15	20
KRLE040200	20	15
KRLE040300	25	10
KRLE040400	32	5
KRLE040500	40	5
KRLE040600	50	2

Seal kit



Code	DN	Pack
5004000130	15	20
5004000140	20	15
5004000150	25	10
5004000160	32	10
5004000170	40	10
5004000180	50	10

Handle

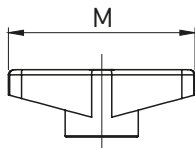
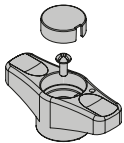

Code	DN	M	Pack
KRMN041100	15-20	74	20
KRMN040300	25	94	10

Lever

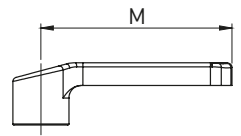
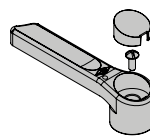

Code	DN	M	Pack
KRLE041100	15-20	92	20
KRLE041200	25-32	124	20
KRLE041300	40-50	147	10

ITEM SPECIFICATIONS

T4J: Shut-off valve

Top Entry shut-off valve with removable ball and full flow with single-piece body with temperature sensor and/or swivel nut for meter connection. Complies with the EN 13828 standard. Chrome plated brass ball with anti-stagnation hole. Accessories with painted aluminium lever or handle. 90 degree control. Temperature range 0-150 °C (peak). Maximum pressure PN 40 bar.

