

# K4.1

## SINGLE SHUT-OFF

Data sheet  
MCTW021.00 - 05/2019



- K4.1 compact shut-off cock
- Main shut-off
- With flush-mounting, serviceable Sandwich box
- The FASTEC® connection is convenient and safe to work with
- The faceplates make it possible to access the shut-off valves
- The faceplate Design and finishes are suitable for exposed installation
- TOP-ENTRY® removable shut-off unit with Soft Turn® anti-jamming ball



Material			
Body	Sandwich Box	Balls	Handle
Brass CW617	ABS	Silicone	Polyamide

## TECHNICAL SPECIFICATIONS

Connections	Working pressure	Temperature	Standard and certification
FASTEC® Eurocono (ISO 228-1)	PN10 (10 bar)	0°C + 95 °C	DIN EN 13828 - DVGW W570-1

## VERSIONS AND CODES

Shut-off valves for domestic water systems \*



**B03** Compatible faceplate

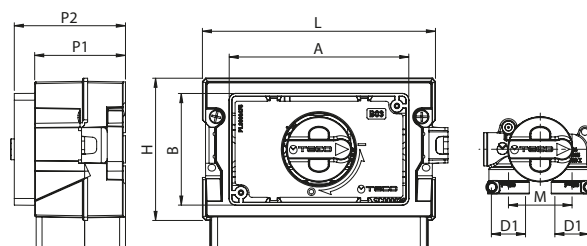

Code	DN	D1	M	L	H	P1	P2	A	B	Faceplate	Pack
K401BE10100	15	EK3/4"	42	154	94	60	73	119	74	B03	10
<b>F</b> K401BF10100	15	F13	42	154	94	60	73	119	74	B03	10
<b>F</b> K401BF30100	20	F14	52,5	194	94	60	73	119	74	B03	5

\* Includes: fixing brackets, site protection cover. Does not include: faceplate and fittings.

**F** **FASTEC**  
STORE The shut-off devices USE FASTEC® STORE FITTINGS.

TECO Srl  
Via Sandro Pertini, 39/41 - Zona industriale Noccole, 25050 Provaglio d'Iseo (BS)

+39 030 6850510 | +39 030 6850555  
info@tecosrl.it | www.tecosrl.it

**TECO**  
INNOVATING SAFETY

## FACEPLATES

B03

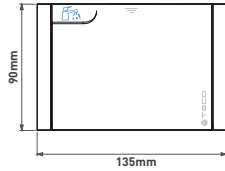

Code		Finish	Pack
KPLB0301600		White	10
KPLB0301M00		Polished chrome	5
KPLB0301800		Silver	5
KPLB0301A00		Black	5
KPLB0301700		Copper	5

## FUNCTION AND TECHNOLOGIES



### TWIN 1 FITTING

Fastec® Twin fittings make it possible to increase the number of connections. In this way you can simplify complex system solutions.

The FASTEC® TWIN Fitting can be used either upstream or downstream from the device.

**COD. KA00F10001**

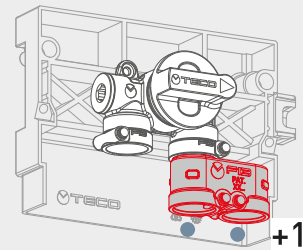

## TECO-CONTROL

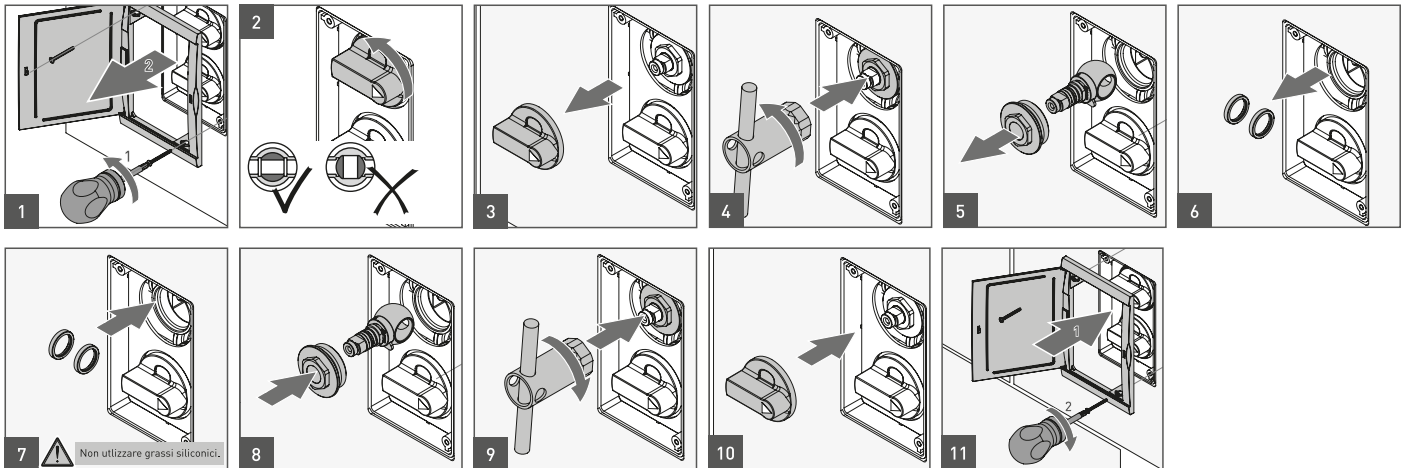

TECO Srl  
Via Sandro Pertini, 39/41 - Zona industriale Noccole, 25050 Provaglio d'Iseo (BS)

+39 030 6850510 | +39 030 6850555  
info@tecosrl.it | www.tecosrl.it



## FASTEC ACCESSORIES

### TWIN 1 fitting



FASTEC® TWIN fitting

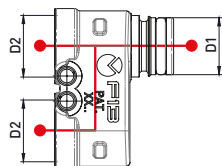

	Code	D1	D2	Pack
F	KA00F10001	F13M	2xF13F	10

## FITTINGS

### Eurocono adapter - flat seal



EUROCONO adapter - Flat Seal

Code	D1 ISO 228-1	Pack
AP004003	3/4"-EK	10

### Eurocono compression fitting for multi-layer composite pipes



EUROCONO compression fitting for connecting multi-layer composite pipes

Code	D1 ISO 228-1	D2 PIPE	Pack
KA00K00005	3/4"-EK	16x2	10
KA00K00006	3/4"-EK	20x2	10

## ACCESSORIES

### Modular extension kit

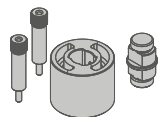

Extension -23mm- modular + screws + faceplate extensions

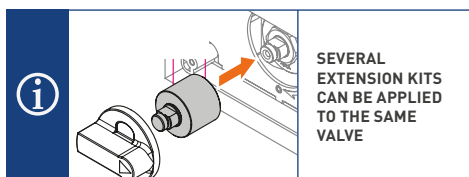

SEVERAL EXTENSION KITS CAN BE APPLIED TO THE SAME VALVE

Code	Pack
KPR0001	1

### Maintenance frame

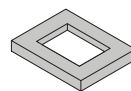

THE MAINTENANCE FRAME IS USED WHEN THE BOX IS INSTALLED INCORRECTLY AND PROTRUDES FROM THE WALL

Code	DN	Pack
KRPL0004	150x100x20 mm	1

## SPARE PARTS

### TECO-control kit



TECO-CONTROL spare parts kit

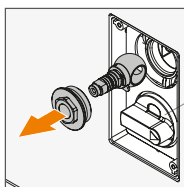

Code	DN	Pack
KR00K00001	15	1

### Handle kit

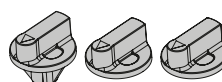

2 BLUE (TOP + BOTTOM) 1 RED

Code	Colour	Pack
KA00K40001	BLUE / RED	1

## FLOW LOSS DIAGRAM

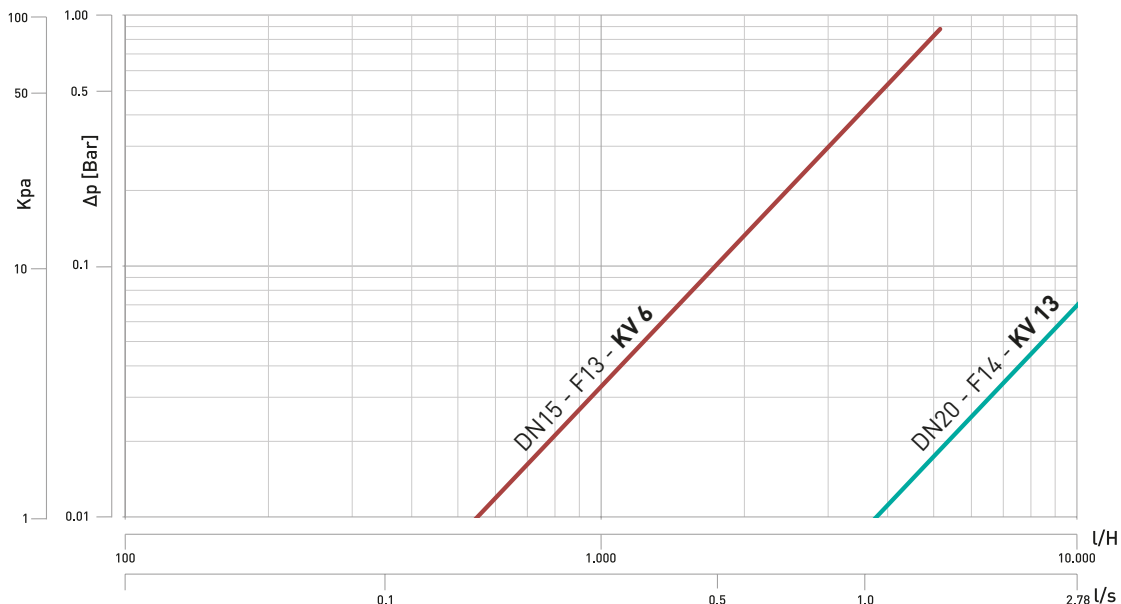

## ITEM SPECIFICATIONS

### K4.1: Single shut-off valve

Hot and cold valve with removable ball, complies with the EN 13828 standard, with light “soft turn” control, complete with easily accessible sandwich box. Brass body with Top Entry system. Brackets and protection covers included. Opens and closes by operating the handle, manually operable faceplate available in five colours. Maximum temperature 80°C.

