

K4.0

DUAL SHUT-OFF

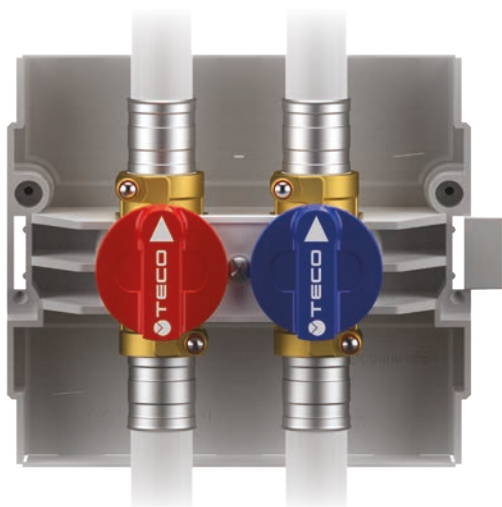

- K4.0 is a compact shut-off kit
- Main shut-off
- With flush-mounting, serviceable Sandwich box
- The FASTEC® connection is convenient and safe to work with
- The compact faceplates make it possible to access the shut-off valves
- The faceplate Design is suitable for exposed installation
- TOP-ENTRY® removable shut-off unit with Soft Turn® full-flow anti-jamming balls



Material			
Body	Sandwich Box	Balls	Handle
Brass CW617	ABS	Silicone	Polyamide

TECHNICAL SPECIFICATIONS

Connections	Working pressure	Temperature	Standard and certification
FASTEC® Eurocono (ISO 228-1) F threaded (EN10226)	PN10 (10 bar)	0°C + 95 °C	DIN EN 13828 - DVGW W570-1

VERSIONS AND CODES

Shut-off valves for domestic water systems *



B03 Compatible faceplate

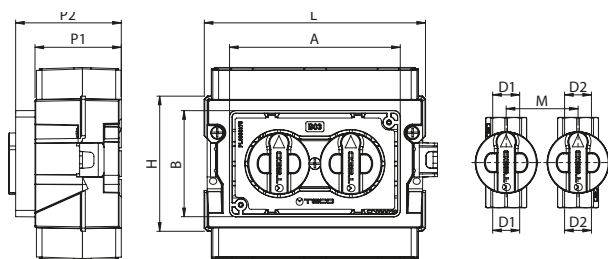

Code	DN	D1	D2	M	L	H	P1	P2	A	B	Pack
K400BE10100	15	EK3/4"	EK3/4"	50	154	115	60	73	119	74	10
F K400BF10100	15	F13	F13	50	194	115	60	73	119	74	10
K400B110100	15	Rp1/2"	Rp1/2"	50	154	115	60	73	119	74	10
F K400BF30100	20	F14	F14	50	194	154	60	73	119	74	5
K400B110200	20	Rp3/4"	Rp3/4"	50	194	154	60	73	119	74	5
F K400BF50100	15/20	F13	F14	50	194	154	60	73	119	74	5

* Includes: fixing brackets, site protection cover. Does not include: faceplate and fittings.



The shut-off devices USE FASTEC® STORE FITTINGS.

FACEPLATES

B03

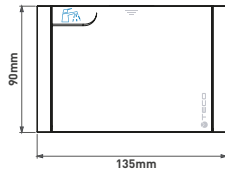

Code		Finish	Pack
KPLB0301600		White	10
KPLB0301M00		Polished chrome	5
KPLB0301800		Silver	5
KPLB0301A00		Black	5
KPLB0301700		Copper	5

FUNCTION AND TECHNOLOGIES



FASTEC® Twin fittings make it possible to increase the number of connections. In this way you can simplify complex system solutions.

TWIN 2 FITTING
COD. KA00F10002

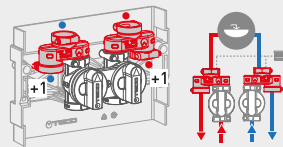

FASTEC® plug
COD. KA00K00002

TWIN 1 FITTING
COD. KA00F10001

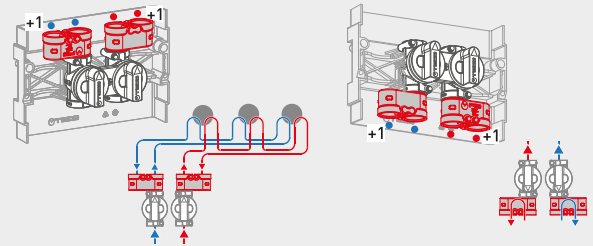

TECO-CONTROL

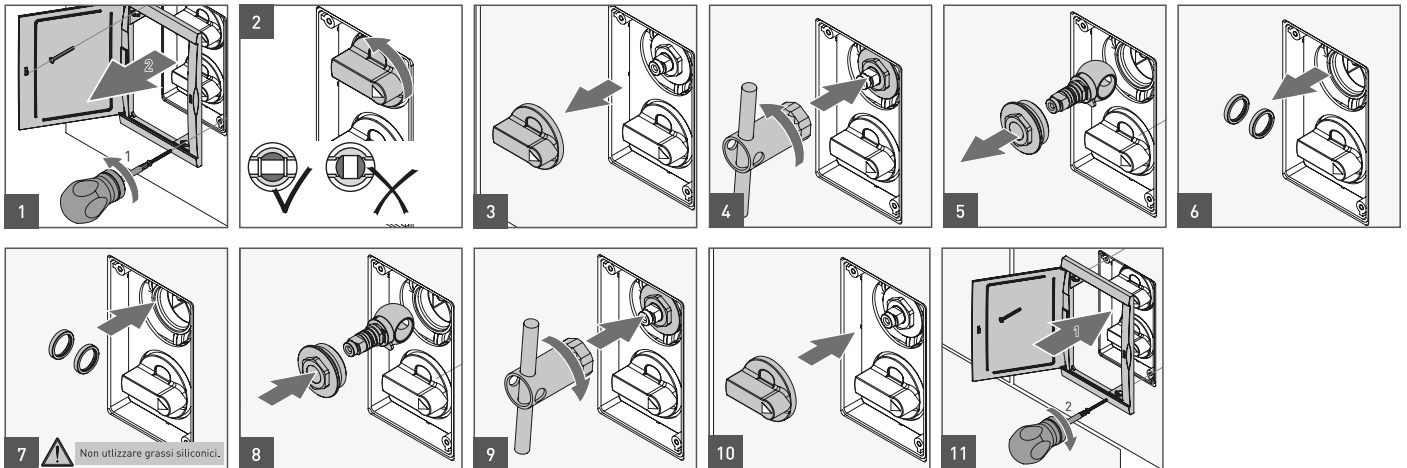

FASTEC ACCESSORIES

TWIN 1 fitting



FASTEC® TWIN fitting

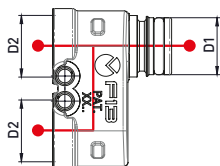

Code	D1	D2	Pack
F KA00F10001	F13M	2xF13F	10

TWIN 2 fitting



FASTEC® TWIN T fitting

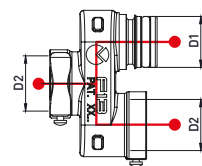

Code	D1	D2	Pack
F KA00F10002	F13M	2xF13F	10

FITTINGS

Eurocono adapter - flat seal



EUROCONO adapter - Flat Seal

Code	D1 ISO 228-1	Pack
AP004003	3/4"-EK	10

Eurocono compression fitting for multi-layer composite pipes

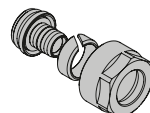

EUROCONO compression fitting for connecting multi-layer composite pipes

Code	D1 ISO 228-1	D2 PIPE	Pack
KA00K00005	3/4"-EK	16x2	10
KA00K00006	3/4"-EK	20x2	10

ACCESSORIES

Modular extension kit

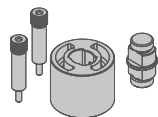

Extension -23mm- modular + screws + faceplate extensions

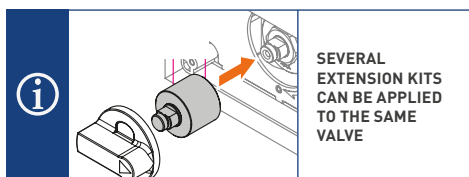

Code	Pack
KPR0001	1

Maintenance frame

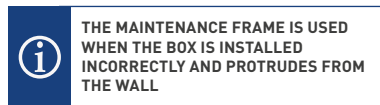
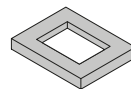

Code	DN	Pack
KRPL0004	150x100x20 mm	1

SPARE PARTS

TECO-control kit



TECO-CONTROL spare parts kit

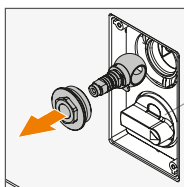

Code	DN	Pack
KR00K00001	15	1

Handle kit

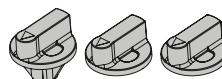

2 BLUE (TOP + BOTTOM) 1 RED

Code	Colour	Pack
KA00K40001	BLUE / RED	1

FLOW LOSS DIAGRAM

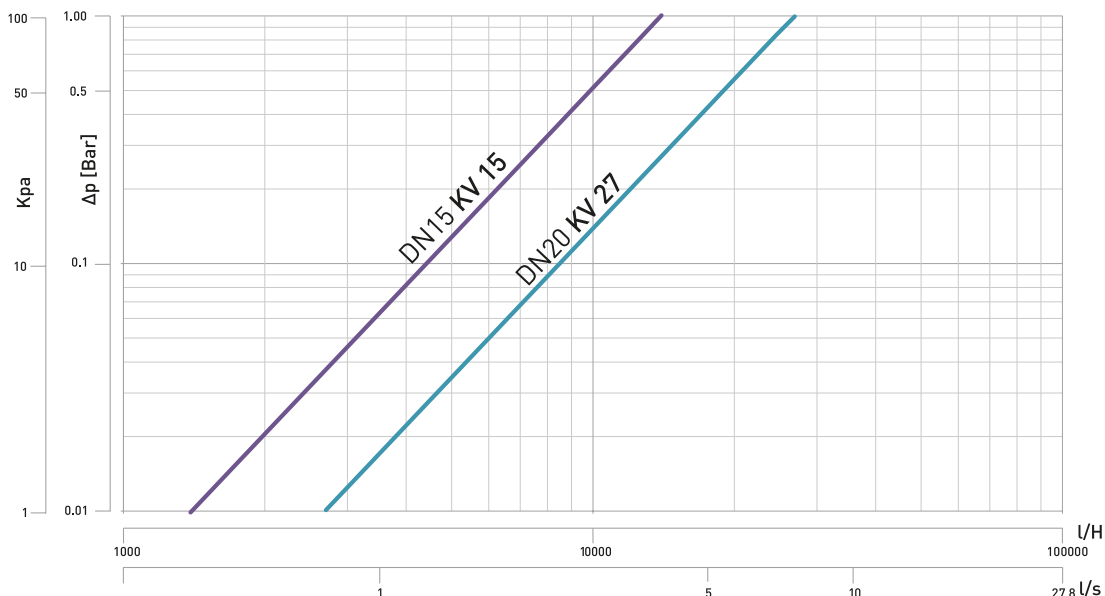

ITEM SPECIFICATIONS

K4.0: "DUPLEX" dual shut-off valve

Kit with dual hot and cold valve with removable ball, conforms to the DIN EN 13828 standard, with light "soft turn" control, complete with easily serviceable sandwich box. Brass body with Top Entry system. Brackets and protection covers included.

Opens and closes by operating the handles, manually operable faceplate available in five finishes.

Temperature: 0 °C + 95 °C.

Working pressure: 10 bar.

