

K4.3

PRE-ASSEMBLED FLUSH-MOUNTING MULTIPLE SHUT-OFF DOMESTIC WATER MANIFOLD KIT

Technical data sheet
MCTW018.01 - 12/2023



FIND OUT MORE

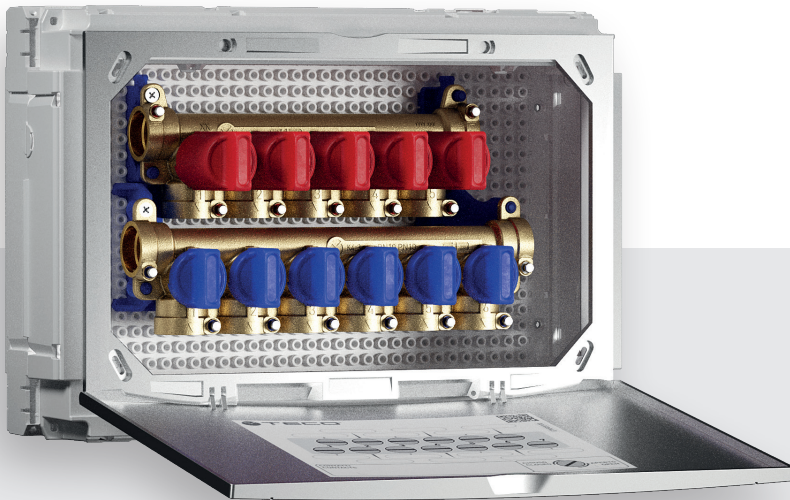

APPLICATIONS

- For hot and cold drinking water
- Renovations / new buildings
- Plasterboard/masonry walls.
Minimum thickness 100 mm

TECHNICAL DATA

Pressure:	PN10 (10 bar)
Temperature:	+ 65 °C (+ 90 °C x60')
Valve certification:	DIN DVGW EN 13828 - W570-1
Material certification:	KTW-BWGL



Patent pending

MATERIALS

Body:	Stamped and sandblasted CW617N brass
Balls:	Engineered polymer
Ball seals:	VMQ
OR:	EPDM
Handles:	Blue/Red PA66 (Polyamide)
Sandwich box:	Polyester

FEATURES

- **K4.3 compact flush-mounting domestic water distribution manifold kit.**
- Shut-off valves on the individual outlets.
- Different configurations **up to 7 cold + 6 hot outlets.**
- **Design faceplate with magnetic closure**, available in a range of finishes.
- Full port valve with **"Soft Turn" ANTI-JAMMING** control.
- Pre-assembled in a serviceable sandwich box with knock-outs on all four sides.
- Identification of utilities with stickers to be applied to the control hand wheel or inside the faceplate.
- Fast system connections **FASTEC®**

TECO Srl
Via Sandro Pertini, 39/41 - Zona industriale Noccole, 25050 Provaglio d'Iseo (BS)

+39 030 6850510 | +39 030 6850555
info@tecosrl.it | www.tecosrl.it



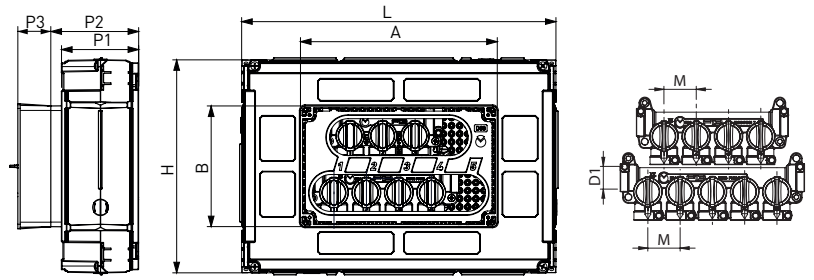
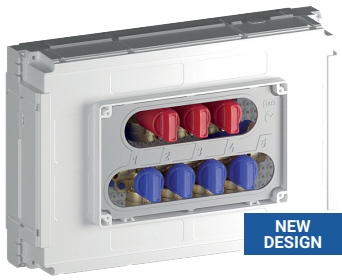

Kit code	Outlets cold	Outlets hot	DN	Connections	D1	M	L	H	P1	P2	P3	A	B	Pack
				FASTEC®										
K403DF10200	4	3	DN10	F13	F13	32	310	210	76	87	33	194	119	5
K403DF10100	5	4	DN10	F13	F13	32	310	210	76	87	33	194	119	5

Includes: fixing brackets, site protection and adhesive labels for utility identification.

Does not include: faceplate **D03** and fittings.

Application examples

Inlet from below or above

RF12210100

KA00K00002

Tight spaces:
The new design of the K4.3 allows for inlets from below or above within the box.

Downward recirculation configuration

RF12210100

KA00F10001

D03 Faceplate with magnetic door for K4.3 with 4+3 and 5+4 outlets

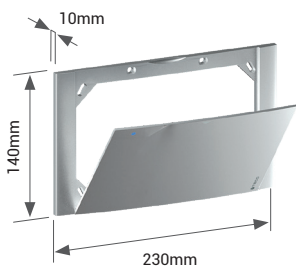

Door dimensions D03:
230 x 140 x 10 mm

Accessories:
• Fixing screws

Code	Finish	Pack
KPLD0301600	White	5
KPLD0301M00	Polished chrome	1
KPLD0301800	Silver	1
KPLD0301A00	Black Soft Touch	1

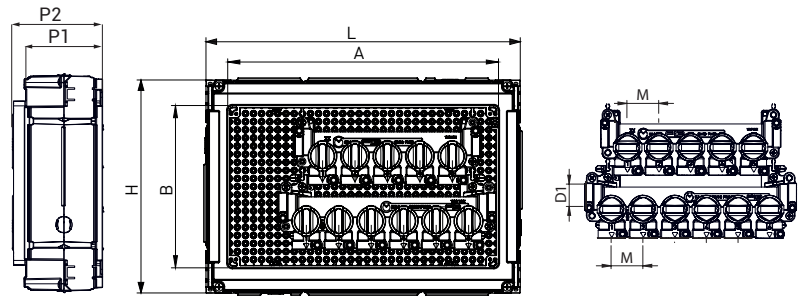

Kit code	Outlets cold	Outlets hot	DN	Connections	D1	M	L	H	P1	P2	P3	A	B	Pack
				FASTEC®										
K403EF10100	6	5	DN10	F13	F13	32	310	210	76	87	33	267	160	5

Includes: fixing brackets, site protection and adhesive labels for utility identification.

Does not include: faceplate **E03** and fittings.

UTILITY EXTENSION: possible combinations with K4.3 manifold up to 7+6 outlets

The 6+5 manifold can be adapted to various requirements with up to a maximum of 7+6 outlets, thanks to the addition of the Fastec T-valve.

T-Valve	DN	Connections	KV*	Pack
		FASTEC®		
T4P12C2100	DN10	F13 F / M / F	4.0	5

* Flow rate m³/h for a pressure drop of 1 bar.

No. of additional T-valves	Outlets cold	Outlets hot
x2	7	6
x1	6	6
x1	7	5

Main shut-off valves can also be fitted (page 4)

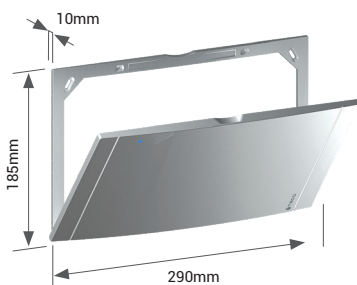

Door dimensions E03:



290 x 185 x 10 mm

Accessories:



- Fixing screws

Code	Finish	Pack
KPLE0301600	White	5
KPLE0301M00	Polished chrome	1
KPLE0301800	Silver	1
KPLE0301A00	Black Soft Touch	1

F13 Adapters

	Code	Description	Pack
	RF12210100	F13 90° M / F	10
	KA00F10001	Dual joint F13 Twin F / F / M	10
	KA00K00002	F13 Plug M	10

F13 KV 5.8 BOOST Valves

Code	DN	Connection	KV**	Pack
		FASTEC®		
 T4P32C2100	DN15	F13 F / M / F	5.8	10
 *T4P32C3100	DN15	F13 M / F / F	5.8	10

* For main RIGHT-HAND shut-off.
 ** Flow rate m³/h for a pressure drop of 1 bar.

Application examples for K4.3 6+5 manifold with FASTEC KV 5.8 BOOST valve

The BOOST valve can be used as a main shut-off (Example A), or to convert a 6+5 manifold into 7+6 with a higher flow rate outlet (Example B).

A

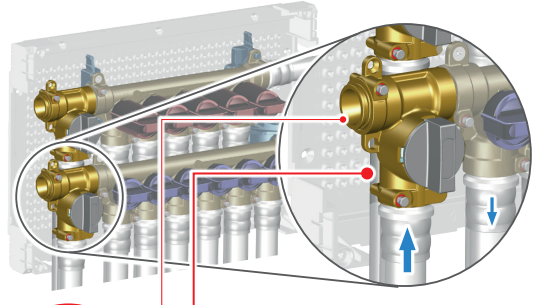

KA00K00002

B

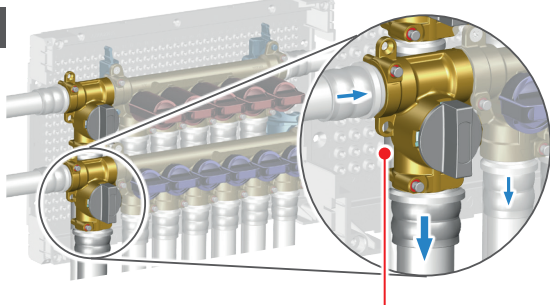

T4P32C2100

FASTEC®
 THE FAST AND SECURE PLUMBING CONNECTION
 Plumbing connection with pin locking.



Discover the whole range.

HOW TO CHOOSE FASTEC?

The table shows the correspondence between Fastec connections and commonly used diameters.

TRADITIONAL CONNECTIONS			
FASTEC®	DN	INCHES	MULTILAYER / PEX PIPE
F13	15	1/2"	Ø 12 - 16 - 20 - 25 - 26



M - Connection Male



F - Connection Female

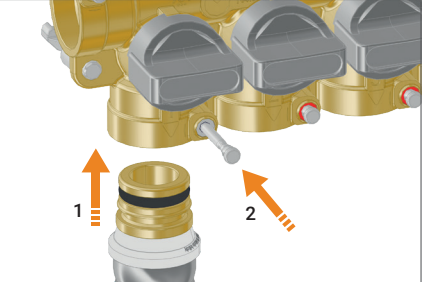

1. Insert the fitting with the pin raised.
2. Lower the locking pin to secure the connection.

TECO control kit for K4.3 flush-mounting multiple shut-off domestic water manifold kit

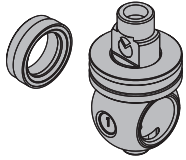

Code	DN	Pack
KR00K00002	DN10	1

VALVE MAINTENANCE - TECO CONTROL

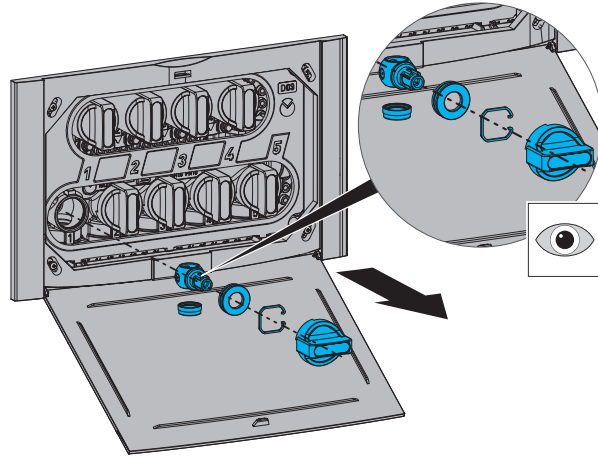

Handle kit for K4.3 flush-mounting multiple shut-off domestic water manifold kit

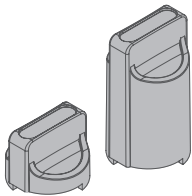

Includes:
Control handle kit (2)

Code	Colour	Pack
KA00K40004	BLUE / RED	1

Maintenance frame for K4.3 flush-mounting multiple shut-off domestic water manifold kit **D03** Compatible faceplate

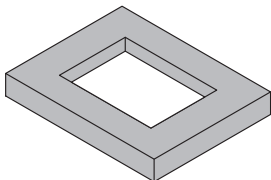

Maintenance frame dimensions compatible with plate **D03 :**
250 x 160 x 20 cm

Code	Pack
KRPL0005	1



THE MAINTENANCE FRAME IS USED WHEN THE BOX IS INSTALLED INCORRECTLY AND PROTRUDES FROM THE WALL.

PRESSURE DROP DIAGRAM

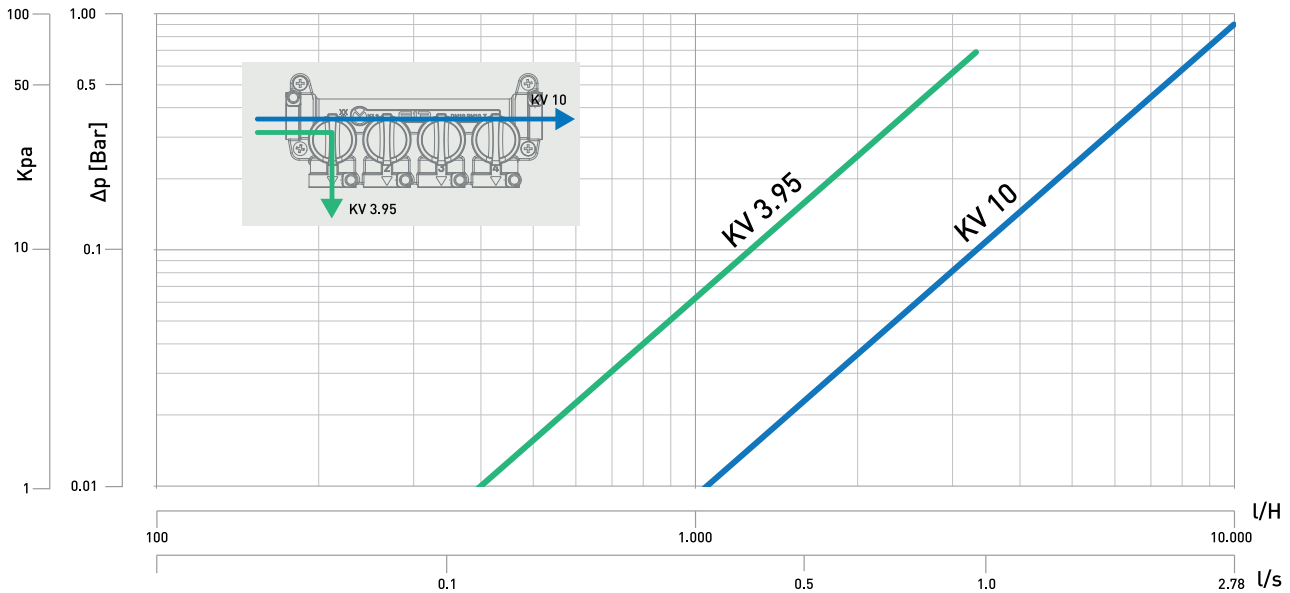

SPECIFICATION TEXT

K4.3: Flush-mounting multiple shut-off manifold kit with 4+3 and 5+4 outlets

A compact pre-assembled distribution manifold kit with 5 cold + 4 hot outlets (K403DF10100) or 4 cold + 3 hot outlets (K403DF10200), brass body with Top Entry removable shut-off valves on each outlet in accordance with the EN 13828 standard, with "Soft Turn" seals and PPSU full-flow balls. Quick coupling fittings with FASTEC F13 technology and locking pin. Sandwich box housing made of impact-resistant PS, with plaster protection cover. Faceplate with manually openable door, available in four colours.

Maximum temperature (peak) 90 °C x60'.

Maximum working temperature +65 °C.

Maximum pressure PN10 (10 bar).

K4.3: Flush-mounting multiple shut-off manifold kit with 6+5 outlets

A compact pre-assembled distribution manifold kit with 6 cold + 5 hot outlets (K403EF10100), brass body with Top Entry removable shut-off valves on each outlet in accordance with the EN 13828 standard, with "Soft Turn" seals and PPSU full-flow balls. Quick coupling fittings with FASTEC F13 technology and locking pin. Sandwich box housing made of impact-resistant PS, with plaster protection cover. Faceplate with manually openable door, available in four colours.

Maximum temperature (peak) 90 °C x60'.

Maximum working temperature +65 °C.

Maximum pressure PN10 (10 bar).



FIND OUT MORE