



# G2 - R2 - R4

VALVES FOR GAS APPLIANCES



**G2 - R2 - R4**

Valves for gas appliances are designed and manufactured for maximum system safety.

All G2-R2-R4 series valves have a built-in thermally activated Firebag® safety device.

In addition, Tecoblock handles for G2 series valves are designed to prevent accidental opening.

VALVES FOR GAS APPLIANCES WITH FIREBAG® THERMAL SAFETY DEVICE AND TECOBLOCK HANDLE

G2



APPLICATIONS

- For all types of gas as specified in EN 437 and DVGW G260 (Methane, Butane, Propane and **Hydrogen**).



TECHNICAL DATA

Temperature	-20 °C ÷ +60 °C
Working pressure	MOP 5 (5 bar)
Connections	EN 10226-1 R/Rp thread G ISO 228-1
High temperature resistance	HTB 5 bar 650 °C for 30' (C5)
Activation temperature FIREBAG	100°C -5K
Reference standards	DIN EN 331 DIN 3586 EU 2016 / 426 regulation DVGW ZP 4110

FEATURES

- Ball valves for gas appliances with FIREBAG® thermal safety device.
- Suitable and certified in accordance with EN 437 and DVGW G260 for gas systems up to 100% hydrogen.
- G2 DIN EN 331 certified ball valves are equipped with the FIREBAG® thermal safety device to block gas flow in the event of fire.
- They have Tecoblock handles to protect against accidental opening.
- The range includes both the straight and elbow version, in DN15-20-25 sizes.
- They are designed and built to guarantee maximum safety in gas systems.
- Finish: chrome-sandblasted.

TECOBLOCK HANDLE

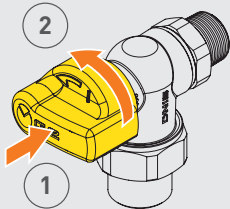

The Tecoblock system is designed to lock the valve in the closed position so that it cannot be opened accidentally, but only after pressing the handle.

FIREBAG® - TAE (see page 150)

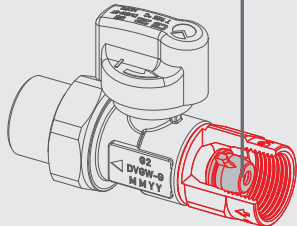

The valves have a FIREBAG® thermal safety device built into the steel inlet fitting. This solution makes it possible to leave the valve dimensions unchanged. FIREBAG® complies with the requirements of the DIN 3586 standard and activates at a temperature of 100°C-5K and withstands up to 650°C for 30 minutes at a pressure of 5 bar.

G2 straight valve with FIREBAG®, threaded/threaded fitting version for gas appliances



Code	DN	FIREBAG TAE	Finish	Connections		Pack
				D1	D2 Fitting DIN 3436	
G2T106C00 *	DN15	•	Chromium	Rp 1/2"	Rp 1/2"	15
G2T107C00 *	DN20	•	Chromium	Rp 3/4"	Rp 3/4"	10
G2T110C00	DN25	•	Chromium	Rp 1"	Rp 1"	5

i \* Non-chrome versions available on request.

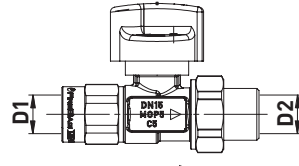

G2 90° valve with FIREBAG®, threaded/threaded fitting version for gas appliances

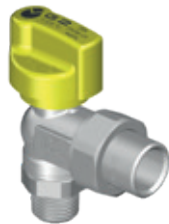

Code	DN	FIREBAG TAE	Finish	Connections		Pack
				D1	D2 Fitting DIN 3436	
G2T406C00	DN15	•	Chromium	R 1/2"	Rp 1/2"	15
G2T407C00	DN20	•	Chromium	R 3/4"	Rp 3/4"	10
G2T410C00	DN25	•	Chromium	R 1"	Rp 1"	5

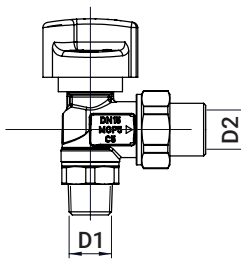

G2 straight valve with FIREBAG®, threaded version for gas appliances and hoses



Code	DN	FIREBAG TAE	Finish	Connections		Pack
				D1	D2	
G2T100C00	DN15	•	Chromium	Rp 1/2"	G 1/2"	20

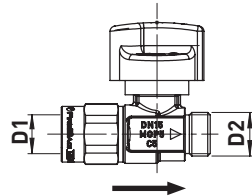

G2 90° valve with FIREBAG®, threaded version for gas appliances and hoses



Code	DN	FIREBAG TAE	Finish	Connections		Pack
				D1	D2	
G2T400C00	DN15	•	Chromium	R 1/2"	G 1/2"	20

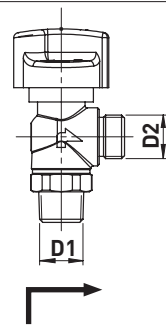



VALVES FOR GAS APPLIANCES WITH BAYONET HOSE CONNECTIONS VERSION WITH HANDLE

R2



APPLICATIONS

- Suitable for all types of gas as specified in EN 437 and DVGW G260/2013 standards (Methane, Butane, Propane).



TECHNICAL DATA

Temperature	-20 °C ÷ +60 °C
Working pressure	MOP 0.5 (0.5 bar)
Connections	Thread EN 10226-1 Bayonet DIN 3383-1
High temperature resistance	HTB 0.5 bar 650 °C for 30' (GT 0.5)
Activation temperature FIREBAG	100°C -5K
Reference standards	DIN EN 15069 DIN 3586 DIN 3383-1



FEATURES

- Shut-off valve with front control for hoses.**
- The bayonet connection ensures the hose can be connected and disconnected safely. The hose can only be connected or disconnected when the valve is closed, and the valve will not open if the hose is not inserted properly.
- The valve comes with a built-in **FIREBAG® thermal safety device** to block gas flow in the event of fire.
- The R2 valve can also be installed outdoors in temperatures down to -20 °C.

FIREBAG® - TAE (see page 150)

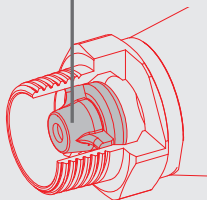

The valve has a thermal FIREBAG® safety device built into the steel inlet fitting. FIREBAG® complies with the requirements of the DIN 3586 standard and activates at a temperature of 100°C -5K and withstands up to 650°C for 30 minutes at a pressure of 5 bar.

R2 90° valve for gas appliances

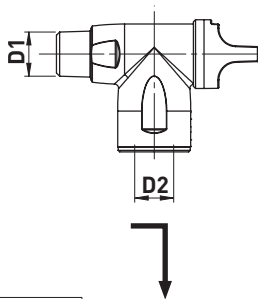

Code	DN	FIREBAG TAE	Finish	Connections		Pack
				D1	D2	
R221100100	DN12	•	Polished chrome	R 1/2"	DIN 3383-1	20

RTD DIN-EN14800:2007 hose for gas appliance valves

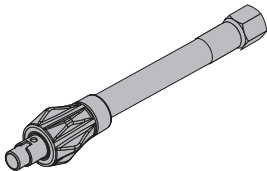

- Material:**
- AISI 321 stainless steel pipe
  - Transparent PVC sheathing
  - AISI 304 stainless steel nut
  - PA 6 grip

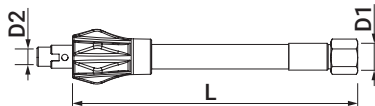

Code	Length (mm)	Connections		Pack
		D1	D2	
R4TD0500	500	Rp 1/2"	DIN 3383-1	1
R4TD0800	750	Rp 1/2"	DIN 3383-1	1
R4TD1000	1000	Rp 1/2"	DIN 3383-1	1
R4TD1250	1250	Rp 1/2"	DIN 3383-1	1
R4TD1500	1500	Rp 1/2"	DIN 3383-1	1
R4TD2000	2000	Rp 1/2"	DIN 3383-1	1



SAFE CONNECTION

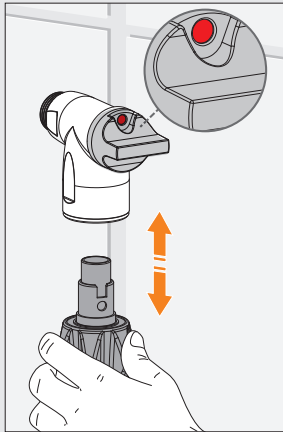

Hose insertion is **QUICK** and **SAFE** The hose can only be disconnected when the valve is closed.

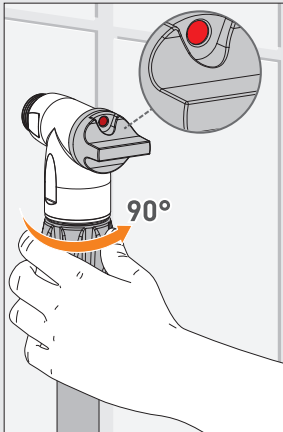

Turning the pipe handle 90° clamps the pipe to the valve so that it can only be opened in this position.

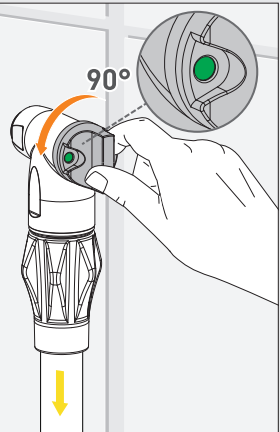

The valve is opened and closed using the control handle on the front.

VALVES FOR GAS APPLIANCES WITH BAYONET HOSE CONNECTIONS

R4



APPLICATIONS

- Suitable for all types of gas as specified in EN 437 and DVGW G260/2013 standards (Methane, Butane, Propane).



TECHNICAL DATA

Temperature	-40 °C ÷ +60 °C
Working pressure	MOP 0.5 (0.5 bar)
Connections	Thread EN 10226-1 Bayonet DIN 3383-1
High temperature resistance	HTB 0.5 bar 650 °C for 30' (GT 0.5)
Activation temperature FIREBAG	100°C -5K
Reference standards	DIN EN 150698 DIN 3586 DIN 3383-1

FEATURES

- Shut-off valves for hoses with control on the hose.**
- The bayonet connection ensures the hose can be connected and disconnected safely. The hose can only be connected or disconnected when the valve is closed, and the valve will not open if the hose is not inserted properly.
- The valve comes with a built-in **FIREBAG® thermal safety device** to block gas flow in the event of fire.
- Manufactured by TECO since 1992.
- The R4 valve can also be installed outdoors in temperatures down to -40 °C.

FIREBAG® - TAE (see page 150)

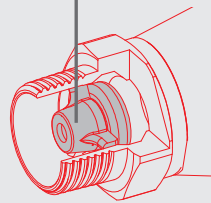

The valve has a thermal FIREBAG® safety device built into the steel inlet fitting. FIREBAG® complies with the requirements of the DIN 3586 standard and activates at a temperature of 100°C -5K and withstands up to 650°C for 30 minutes at a pressure of 5 bar.

R4 90° valve for gas appliances

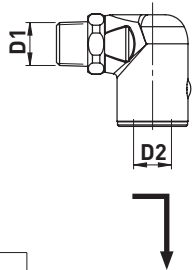

Code	DN	FIREBAG TAE	Finish	Connections		Pack
				D1	D2	
R4TAS030C00	DN12	•	Polished chrome	R 1/2"	DIN 3383-1	20

i Version without FIREBAG® available on request.

RTD DIN-EN14800:2007 hose for gas appliance valves

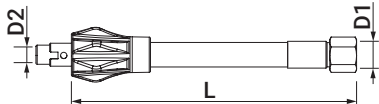
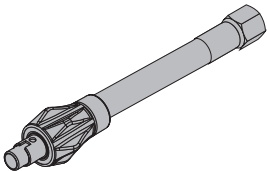

Material:

- AISI 321 stainless steel pipe
- Transparent PVC sheathing
- AISI 304 stainless steel nut
- PA 6 grip

Code	Length (mm)	Connections		Pack
		D1	D2	
R4TD0500	500	Rp 1/2"	DIN 3383-1	1
R4TD0800	750	Rp 1/2"	DIN 3383-1	1
R4TD1000	1000	Rp 1/2"	DIN 3383-1	1
R4TD1250	1250	Rp 1/2"	DIN 3383-1	1
R4TD1500	1500	Rp 1/2"	DIN 3383-1	1
R4TD2000	2000	Rp 1/2"	DIN 3383-1	1



SAFE CONNECTION

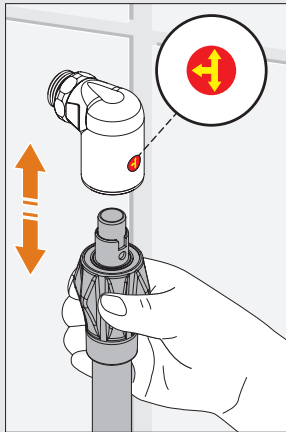

Hose insertion is QUICK and SAFE The hose can only be disconnected when the valve is closed.

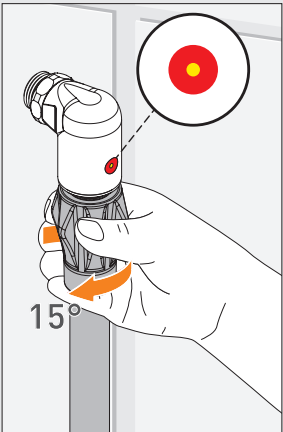

Turning the pipe handle 15° clamps the pipe to the valve so that it can only be opened in this position.

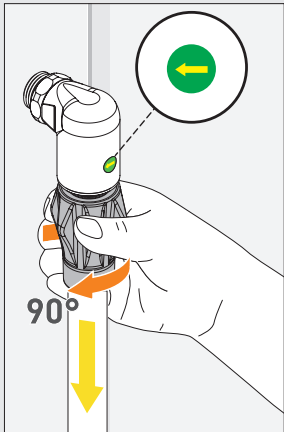

Turning the hose handle further opens the gas flow. The hose cannot be disconnected with the valve open.